

---

# User Guide

Nokia Asha 502 Dual SIM

**NOKIA**

# User Guide

Nokia Asha 502 Dual SIM

## Contents

<b>Safety</b>	<b>4</b>	Add social info to contacts	<b>21</b>
<b>Get started</b>	<b>5</b>	Update your status	<b>21</b>
Keys and parts	5	Send a message	21
Insert the SIM card and battery	5	Mail for Exchange	22
Insert a second SIM card	6	Set up your mail account	23
Insert a memory card	7	Send a mail	23
Charge the battery	8	Chat with your friends	24
Set which SIM card to use	9	Check your voice mail	25
Copy contacts from your old phone	9	<b>Camera</b>	<b>26</b>
<b>Basics</b>	<b>11</b>	Take a photo	26
Display indicators	11	Record a video	26
Touch screen actions	11	Share your photo or video	27
Switch between views	13	<b>Maps &amp; navigation</b>	<b>28</b>
Check your activity	13	Find nearby places	28
Change settings quickly	14	<b>Internet</b>	<b>29</b>
Prolong battery life	14	Browse the web	29
Reorganise the apps menu	15	Add a website to your favourites	29
Personalise the lock screen	15	<b>Entertainment</b>	<b>31</b>
Change your ringtone	16	Play a song	31
Add a full keyboard or phone keypad	16	Listen to the radio	31
Add a writing language	16	<b>Office</b>	<b>32</b>
Keys on the keyboard	16	Change the time and date	32
Write using the keyboard	17	Set an alarm	32
Keys on the keypad	17	Add a calendar entry	32
Write using the keypad	18	<b>Phone management &amp; connectivity</b>	<b>34</b>
Use predictive text	18	Share your content using Slam	34
Nokia Store	18	Connect to a Wi-Fi network	34
<b>People &amp; messaging</b>	<b>20</b>	Copy content between your phone and computer	35
Make a call	20	Update your phone software	35
Save a name and phone number	20		

Use your phone in flight mode	36
Access codes	36
<b>Product and safety information</b>	<b>38</b>

# Safety

Read these simple guidelines. Not following them may be dangerous or illegal. For further info, read the complete user guide.



## SWITCH OFF IN RESTRICTED AREAS

Switch the device off when mobile phone use is not allowed or when it may cause interference or danger, for example, in aircraft, in hospitals or near medical equipment, fuel, chemicals, or blasting areas. Obey all instructions in restricted areas.



## ROAD SAFETY COMES FIRST

Obey all local laws. Always keep your hands free to operate the vehicle while driving. Your first consideration while driving should be road safety.



## INTERFERENCE

All wireless devices may be susceptible to interference, which could affect performance.



## QUALIFIED SERVICE

Only qualified personnel may install or repair this product.



## BATTERIES, CHARGERS, AND OTHER ACCESSORIES

Use only batteries, chargers, and other accessories approved by Nokia for use with this device. Do not connect incompatible products.



## KEEP YOUR DEVICE DRY

Your device is not water-resistant. Keep it dry.



## PROTECT YOUR HEARING

To prevent possible hearing damage, do not listen at high volume levels for long periods. Exercise caution when holding your device near your ear while the loudspeaker is in use.



## SAR

This device meets RF exposure guidelines when used either in the normal use position against the ear or when positioned at least 1.5 centimetres (5/8 inch) away from the body. The specific maximum SAR values can be found in the Certification Information (SAR) section of this user guide. For more info, go to [www.sar-tick.com](http://www.sar-tick.com).

When a carry case, belt clip or other form of device holder is used for body-worn operation, it should not contain metal and should provide at least the above-stated separation distance from the body. Note that mobile devices may be transmitting even if you are not making a voice call.

# Get started

Get to grips with the basics, and have your phone up and running in no time.

## Keys and parts

Explore the keys and parts of your new phone.

- 1 Micro-USB connector
- 2 Audio connector (3.5 mm AHJ)
- 3 Volume/Zoom keys
- 4 Lock/Power key
- 5 Microphone
- 6 Back key
- 7 Touch screen
- 8 Camera lens
- 9 Loudspeaker
- 10 Antenna area

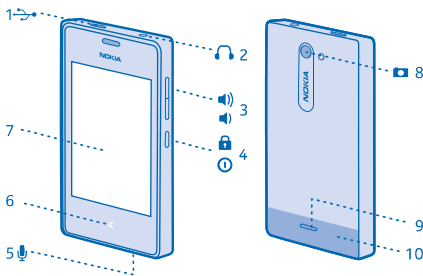

Avoid touching the antenna area while the antenna is in use. Contact with antennas affects the communication quality and may reduce battery life due to higher power level during operation.

Do not connect products that create an output signal, as this may damage the device. Do not connect any voltage source to the audio connector. If you connect an external device or headset, other than those approved for use with this device, to the audio connector, pay special attention to volume levels.

The images in this guide may differ from your device screen.

## Insert the SIM card and battery

Learn how to insert a SIM card and the battery.

1. Press on the camera bezel of the back cover with your thumb, and pull the edge of the back cover until it comes off.

**!** **Note:** Switch the device off and disconnect the charger and any other device before removing any covers. Avoid touching electronic components while changing any covers. Always store and use the device with any covers attached.

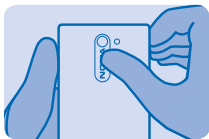

2. If the battery is in the phone, lift it out.



3. Push the SIM in with the contact area face down until it locks into place.

**!** **Important:** This device is designed to be used with a mini-UICC SIM card, also known as a micro-SIM card only. A micro-SIM card is smaller than the standard SIM card. Use of incompatible SIM cards, or use of SIM card adapters, may damage the card or the device, and may corrupt data stored on the card.



4. Line up the battery contacts, and put the battery in.



5. Replace the back cover.

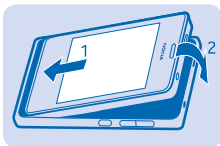

6. To switch on, press and hold the power key until the phone vibrates.

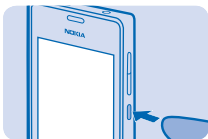

## Insert a second SIM card

You can easily add a second SIM card (SIM2) without removing the battery.

1. Press on the camera bezel of the back cover with your thumb, and pull the edge of the back cover until it comes off.

**!** **Note:** Switch the device off and disconnect the charger and any other device before removing any covers. Avoid touching electronic components while changing any covers. Always store and use the device with any covers attached.

Both SIM cards are available at the same time when the device is not being used, but while one SIM card is active, for example, making a call, the other is unavailable.



2. Push the SIM in with the contact area face down until it locks into place.

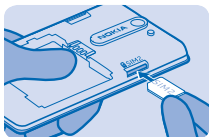

3. To remove the SIM, push the card in until it's released, then pull it out.

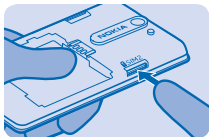

## Insert a memory card

Learn how to insert a memory card into your phone.



Use only compatible memory cards approved for use with this device. Incompatible cards may damage the card and the device and corrupt data stored on the card.

1. Remove the back cover.

**!** **Note:** Switch the device off and disconnect the charger and any other device before removing any covers. Avoid touching electronic components while changing any covers. Always store and use the device with any covers attached.

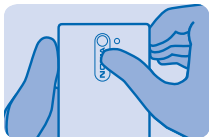

2. Push the card in with the contact area face down until it locks into place.

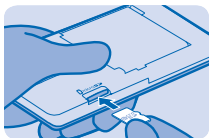

3. To remove the card, push the card in until it's released.

**!** **Important:** Do not remove the memory card when an app is using it. Doing so may damage the memory card and the device and corrupt data stored on the card.



## Charge the battery

Your battery has been partially charged at the factory, but you may need to recharge it before you can use your phone.

1. Plug the charger into a wall outlet.

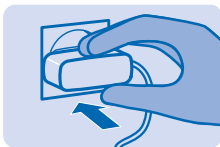

2. Connect the charger to the phone. When done, unplug the charger from the phone, then from the wall outlet.

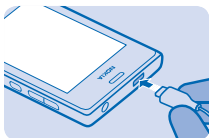



If the battery is completely discharged, it may take several minutes before the charging indicator is displayed or before any calls can be made.

- ★ **Tip:** You can use USB charging when a wall outlet is not available. Data can be transferred while charging the device. The efficiency of USB charging power varies significantly, and it may take a long time for charging to start and the device to start functioning.

## Set which SIM card to use

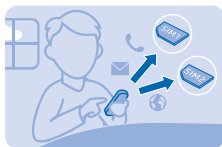

By default, your phone asks you which SIM to use for the connection. You can also set the default SIM for calls or messaging. If you name your SIMs, you can see at a glance which is, for example, for work or personal use.

Tap  **Settings** > **Dual SIM**.

1. Switch **Always ask** to  **Off**.
2. Select which SIM to use for which connection.

### Availability of SIMs

- If you only have one SIM, put it into the SIM1 holder. Some features may only be available with the SIM in the SIM1 holder.
- When you set one SIM to be used for outgoing calls or messages, or for data connections, the other SIM can still receive calls or messages.
- When one SIM is having an active connection, the other SIM is not available.

### Rename SIM

Tap **SIM settings**, and type in the new name under the card you want to name.

## Copy contacts from your old phone

Get all your contacts to your new phone in one go.

Your old phone must have Bluetooth, and the contacts must be stored in the phone memory, not on the SIM.

1. On both your new and old phone, switch Bluetooth on, and make sure both phones are visible to others.
2. On your new phone, tap  **Contacts** > **Import contacts** > **Another device**.

- ★ **Tip:** If you already have contacts on your phone, swipe up from the bottom of the screen, and tap **Import contacts** > **Another device**.

3. Move the phones close to each other. When the phones are connected using Bluetooth, the contacts transfer starts.









If your contacts are written in a language that is not supported by your new phone, the contact info may not show correctly.

# Basics

Learn how to get the most out of your new phone.

## Display indicators

The display indicators on your phone tell you the current time, battery and signal strength, and much more.

-  An alarm is set.
-  The silent profile is on.
-  Battery power level
-  You have new notifications. Swipe down from the top of the screen to see the details.
-  Wi-Fi is on.
-  Signal strength
-  Flight mode is on.
-  Bluetooth is on.

The type of mobile network you're currently connected to may be shown with a single letter, a combination of letters, or a combination of letters and numbers. For example, **2G**, depending on your network service provider.

The icons may vary depending on your region or network service provider.

## Touch screen actions

Explore your phone with a tap or swipe.

1. To open an app or other item, tap the app or item.

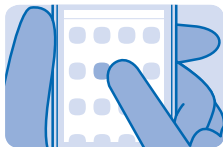

2. To switch a setting on or off, tap the switch.



3. To see more options, tap and hold an item.



4. To swipe, for example, to another home screen, steadily slide your finger left or right.

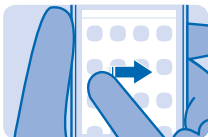

5. To see more options, swipe up from the bottom of the screen if you can see three lines there.



6. To close an app and go back to the home screen, swipe in from the left or right of the screen.



7. To see notifications and change settings, swipe down from the top of the screen. To close the menu, swipe up, or tap an empty area outside the menu.



8. To scroll through a long list or menu, slide your finger quickly up or down, and lift your finger.

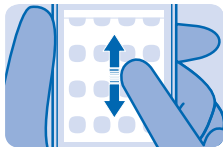

9. To zoom, slide two fingers apart or together on an item.



★ **Tip:** For more info on touch screen actions, tap **i** Care > Nokia Care > Tutorial.

## Switch between views

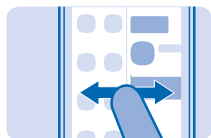

Your phone has 2 home screens: one for keeping up with your activities, and another one for apps.

Swipe left or right to switch between home screens.

Choose your view according to your needs:

- Easily see what you've been doing lately, and check what's happening next in your calendar.
- In the apps menu you can open apps and shortcuts, and rearrange them as you like.

## Check your activity

Your phone makes it easy for you to always keep up with what's happening.

In the apps menu, swipe left or right to view your activities. Here, you can see the following:

- Apps you've opened recently, grouped by date
- Your upcoming calendar events. Swipe down at the top of the activity list to see what you've got planned next.
- Your social networking activities, like status updates and comments
- Your latest messages, missed calls, downloads, recent music, alarms, and more

★ **Tip:** You can easily pause or resume the currently-playing song directly from the list.

★ **Tip:** If you've set up a social networking account, you can post your status update in this screen when you're signed in.

### Clear your activities

Tap and hold an item, and tap . To clear all activity, tap **Clear all**.

### Control your activities

To decide which activities you want to see, tap  **Settings** > **Fastlane**.

## Change settings quickly



Need to quickly switch your phone to silent mode? Rather than going into the phone menus, in most views, you can quickly change some settings and check notifications in the menu that opens from the top of the screen.

1. Swipe down from the top of the screen.

In this screen, you can:



- See your missed calls or unread messages
- Switch your phone to silent mode
- Check for Wi-Fi networks, and connect to them
- Switch Bluetooth on or off

2. To close the menu, press the back key.

## Prolong battery life

Get the most out of your phone while getting the battery life you need. There are steps you can take to save power on your phone.

To save power:

Charge wisely	Always charge the battery fully.
Select only the sounds that you need	Mute unnecessary sounds, such as key press sounds.
Use wired headphones	Use the loudspeaker selectively.
Lower the backlight brightness	Tap  <b>Settings</b> , and drag the <b>Brightness</b> slider.
Set the backlight to switch off after a short time	Tap  <b>Settings</b> > <b>Phone lock</b> , and change the setting for <b>Screen time-out</b> .

---

Use network connections selectively

- Switch Bluetooth on only when needed.
  - To switch off automatic update of a mail account, tap **Accounts** and an account, and switch **Update Inbox** to **Manually**.
  - If you're listening to music or otherwise using your phone, but don't want to make or receive calls, switch flight mode on. Tap **Settings**, and switch **Flight mode** on.
- 

## Reorganise the apps menu

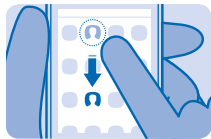

You can organise your apps as you like. Move your favourite apps and shortcuts to the top, or remove shortcuts. You can also uninstall apps you don't need.

1. Tap and hold an item in the apps menu.
2. Drag and drop the item you want to move to a new location. You can move as many items as you like.
3. When you're done, tap the apps menu.

### Remove a shortcut

Tap and hold the shortcut, and tap **X**.

### Uninstall an app

Tap and hold the app, and tap **X**. You may not be able to uninstall some apps.

## Personalise the lock screen

Would you like to make your lock screen unique? You can, for example, have your own favourite photo in the background.

1. To change the wallpaper of the lock screen, tap **Settings > Wallpaper for lock screen**.
2. Tap the photo you want to use, and tap **Set**.

★ **Tip:** You can also use a photo that you've taken with your phone camera.

### Hide notification content on the lock screen

Tap **Settings**, and switch **Notifications** to **Off**.

## Change your ringtone



Set a different ringtone for each SIM card.

1. Tap **Settings** > **Sounds and vibra**.
2. Tap **SIM1 ringtone** or **SIM2 ringtone**.
3. Select a ringtone from a list of preloaded tones or from your downloaded music. The ringtone plays so you can see if you like it.
4. When you've found a ringtone you like, tap **Set**.

- ★ **Tip:** Download more ringtones from Nokia Store. To learn more about Nokia Store, go to [www.nokia.com/support](http://www.nokia.com/support).
- ★ **Tip:** You can also change the message alert tone. Tap **Message tone**, and select a tone.

## Add a full keyboard or phone keypad

You can use either the full keyboard or phone keypad when writing.

Tap **Settings** > **Writing settings** > **Add keyboards**, and tap the keyboards or keypads you want to use.

### Switch between the keyboard and keypad

Swipe left or right on the space key.

This option is available if you have chosen more than one keyboard or keypad.

## Add a writing language

Need to write in another language? You can easily switch between several writing languages. In some countries, the languages have been selected by default.

Tap **Settings** > **Writing settings** > **Add keyboards** and the language.

### Switch between languages when writing

Swipe left or right on the space key.

## Keys on the keyboard

The layout of the keyboard may vary, depending on the writing language, input mode, and character range you use.

To start writing, tap a text box.



- 1 Character keys
- 2 Shift key
- 3 Numbers and symbols key
- 4 Space key
- 5 Enter key
- 6 Backspace key

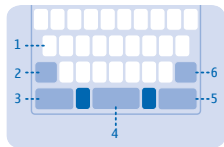

## Write using the keyboard

With the keyboard, you can write your messages in no time.

To type in a character, tap the key.

### Switch between character cases

Tap ⇧.

### Add an accent to a character

Tap and hold the character, then tap the accented character you want. This may not be available in all languages.

### Switch between number and letter mode

Tap the numbers and symbols key or the letter key.

### Type in a special character

Tap the numbers and symbols key, then tap the special character.

### Move the cursor to the next row

Tap ↵.

★ **Tip:** Tap and hold the text until you see the cursor. Without lifting your finger, drag the cursor to the place you want.

### Delete a character

Tap ☒.

## Keys on the keypad

The layout of the keypad may vary, depending on the writing language, input mode, and character range you use.

To start writing, tap a text box.

- 1 Character keys
- 2 Shift key
- 3 Space/Language key
- 4 Smiley key
- 5 Enter key
- 6 Symbol key
- 7 Number key
- 8 Backspace key

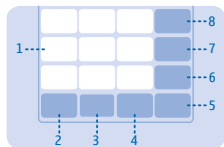

## Write using the keypad

Writing with the keypad is easy and fun.

Tap a character key repeatedly until the character is shown. There are more characters available than are shown on the key.

★ **Tip:** To see all the characters found on a character key, tap and hold the key.

### Switch between character cases

Tap ⇄.

### Switch between number and letter mode

Tap the number key or the letter key.

### Type in a special character

Tap the symbol key, then tap the special character.

### Move the cursor to the next row

Tap ↵.

★ **Tip:** Tap and hold the text until you see the cursor. Without lifting your finger, drag the cursor to the place you want.

### Delete a character

Tap ☒. If it's a compound character, tap the key repeatedly until the character is removed. Compound characters are not available in all languages.

## Use predictive text

To speed up your writing, your phone can guess what you are starting to write. Predictive text is based on a built-in dictionary. This feature is not available for all languages.

To switch predictive text on or off, tap ⚙ **Settings** > **Writing settings** and your language keyboard or keypad, and switch **Prediction** to **On** ☑ or **Off** ☐.

### Use predictive text when writing

Start writing a word, and when the word you want is shown in the suggestion bar, tap the word.

★ **Tip:** To see more suggestions, swipe left on the suggestion bar.

### Correct a word

If you notice that you have misspelled a word, tap it, and you see suggestions for correcting the word.

### Add a new word to the dictionary

If the word you want isn't in the dictionary, write the word, tap it, and tap the plus sign (+) in the suggestion bar.

## Nokia Store

Download mobile games, apps, themes, wallpapers, and ringtones to your phone from Store.

Select **Store**.

Many items are free of charge; some you need to pay for with your credit card or on your phone bill.

The availability of payment methods depends on your country of residence and your network service provider.



To learn more about Store, go to [store.nokia.com](http://store.nokia.com).

# People & messaging

Contact your friends and family, and share your files, such as photos, using your phone. Stay tuned with the latest updates to your social networking services even when on the go.

## Make a call

Learn how to make a call with your new phone.

1. Tap **Phone**.
2. Type in the phone number.  
To type in the + character, used for international calls, tap \* twice.
3. Tap . If asked, select which SIM to use.
4. To end the call, tap .

★ **Tip:** Is your friend's voice too loud or quiet? Press the volume keys to change the volume.

## Answer a call

Swipe down.

## Swap between calls

Tap .

## Decline a call

Swipe up, and tap .

## Reply to a call with a text message

Swipe up, tap , and write your message.

## Call last dialed number

On the activity screen, tap the contact name or phone number you called, and tap .

## View your missed calls

If you missed a call, a notification is shown on the lock screen. Swipe over the notification to see the call info. Then swipe to the activity screen, and tap  to call back.

Missed and received calls are logged only if supported by the network, and if the phone is switched on and within the network service area.

★ **Tip:** To view missed calls later, tap  **Call log** >  > **Missed**.

## Save a name and phone number



Add new contacts to your phone.

1. Tap **Contacts**.
2. Swipe up from the bottom of the screen, and tap **Add new contact**.
3. Write the name, number, and other details.

★ **Tip:** To save a phone number in the dialler, type in the number, and tap **+**.

### Edit the details of a contact

Tap the contact, and swipe up from the bottom of the screen. Then tap **Edit**, and edit the details, such as the mail address or ringtone.

### Add more details

When editing a contact, swipe up from the bottom of the screen, tap **Add details**, and tap a detail.

## Add social info to contacts

Sign in to social networking services to add your friends' info to your phone contacts list.

1. Tap **Contacts**.
2. Swipe up from the bottom of the screen, and tap **Accounts**.
3. Tap an account, or tap **+** to set one up.
4. Select whether you want to import all or only those that are already in your contacts list.

Info from the account shows up in your contacts list.

## Update your status

When you're signed in to your social networking services, you can post your status update on the home screen showing your activity.

1. In the apps menu, swipe left or right to view your activities.
2. Tap **What's on your mind?**, or if not available, tap **Tap here to get connected**.
3. Sign in to a social networking service, and write your status message.
4. Tap **Post**.

## Send a message



With text and multimedia messages, you can quickly contact your friends and family.

1. Tap **Messaging > +**.
2. To add a contact as a recipient, tap **+**, or tap **Add recipient** to start writing a name or typing in a phone number. You can add more than one recipient.
3. Write your message in the text box.

★ **Tip:** To add a smiley, tap **😊**.

4. To add an attachment, such as a photo or video, tap **📎**.

★ **Tip:** You can also take a new photo while writing your message. Tap  > **Camera**, take a photo, and tap **Done**.

5. Tap . If asked, select which SIM to use.

If the item you insert in a multimedia message is too large for the network, the device may automatically reduce the size.

Only compatible devices can receive and show multimedia messages. Messages may look different in different devices.

You can send text messages that are longer than the character limit for a single message. Longer messages are sent as two or more messages. Your service provider may charge accordingly. Characters with accents, other marks, or some language options, take more space, and limit the number of characters that can be sent in a single message.

## Mail for Exchange

Would you like to have your work mail at hand, whether you are sitting by your computer or on the go with your phone? You can sync the important content between your phone and a Microsoft Exchange server.

Mail for Exchange can be set up only if your company has a Microsoft Exchange server. In addition, your company IT administrator must have activated Microsoft Exchange ActiveSync for your account.

Before starting the setup, make sure you have the following:

- A corporate mail address
- Your Exchange server name (contact your company IT department)
- Your network domain name (contact your company IT department)
- Your office network password

Depending on the Exchange server configuration, you may need to type in additional info during the setup. If you don't know the correct info, contact your company IT department.

During the setup, you can define how often you want your phone to sync the content with the server.

With Mail for Exchange, it may be mandatory to use the lock code.

Use of the Mail for Exchange is limited to over-the-air synchronisation of PIM information between the Nokia device and the authorised Microsoft Exchange server.

This device is able to communicate with Microsoft Exchange ActiveSync enabled servers. The provision of this device to you does not grant you, and you do not receive, any rights under any Microsoft intellectual property with respect to any server software, or server device, that is accessed using this device or with respect to use of Microsoft Exchange ActiveSync apart from this device.

## Set up your mail account

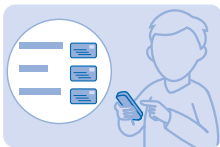

Do you use more than one mail address? You can have several mailboxes on your phone.

You must be connected to the internet to add a mailbox.

If you don't have a mail account, you can set up Nokia Mail. You can create an account during setup.

1. Tap **@ Mail** > **+** and a mail account.
2. Write your username and password.
3. Tap **Sign in**.

★ **Tip:** You can add a Mail for Exchange account to your phone if you want to sync your work or other mail with your phone. Select and a mail account, and type in the required details.

### Add a mailbox later

Tap **@ Mail**, swipe up from the bottom of the screen, and tap **Accounts**. Then tap **+** and an account, and sign in.

### Switch off the automatic update of the inbox

Tap **@ Accounts** and an account. Then tap **Update Inbox**, and change the setting, if needed.

Your phone updates your inbox at certain intervals to show your new mails when they have arrived. This may cause transfer of large amounts of data, which may result in data traffic costs. To save costs, you can switch the automatic update feature off and update your inbox manually using a Wi-Fi connection.

### Delete a mailbox

Tap **@ Accounts**, tap and hold the account, and tap **Delete**.

## Send a mail

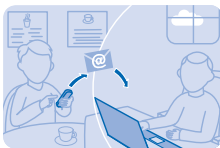

Would you like to send a mail while on the go? With your phone, you can read and send mail, even when not sitting at your desk.

You must be connected to the internet to send and receive mail.



1. Tap **@ Mail** and a mail account.
2. Swipe up from the bottom of the screen, and tap **Compose email**.

3. To add a recipient from your contacts, tap **+**. You can also write the address. You can add more than one recipient.

4. Write the subject and your message.

★ **Tip:** To add a suggested word, tap it. To browse the list, swipe over the suggestions. If you don't want to use this feature, swipe up from the bottom of the screen, and switch **Prediction to Off** .

5. To add an attachment, such as a photo, swipe down to close the keyboard, then swipe up from the bottom of the screen, and tap **Add attachment**.

★ **Tip:** You can also take a new photo while writing your mail. Swipe down to close the keyboard, then swipe up from the bottom of the screen, and tap **Add attachment** >  > . Tap the screen to take a photo, and tap **Done**.

6. Tap **Send**.

### Read a mail

Tap **@ Mail** and a mail account, then tap a message to read it.

★ **Tip:** When viewing your inbox, drag down to refresh it.

## Chat with your friends



Do you like chatting online with your friends? You can send instant messages with your phone when you're out on the town.

You must be connected to the internet to chat.

You need a Nokia account to chat. If you don't have one, you can create a new account during setup. Tap **@ Chat**, type in your username and password, and sign in.

If you have added friends to your chat contacts, they are automatically included in your contacts. If you have no contacts yet, you are asked to invite friends to chat. You can also chat with others than just your chat contacts.

1. Tap **@ Chat**.

2. To start a chat, tap a contact. Green colour indicates that your friend is online.

3. Write your message.

★ **Tip:** To add a smiley, tap .

4. Tap .

Using services or downloading content may cause the transfer of large amounts of data, which may result in data costs.



## Check your voice mail



Did you let your calls go to voice mail when you couldn't answer? Listen to the messages people have left you at a convenient time.

To use voice mail, you may need to subscribe to the service. For more info, contact your network service provider.

Before using your voice mailbox, get your voice mailbox number from your network service provider. Check your order confirmation or your network service provider's support website.

To set up your voice mail, tap **Phone**, and tap and hold **1**, type in your voice mailbox number, and tap **✓**. Your phone automatically calls your voice mail.

1. To check your voice mail when you just missed a call, swipe down from the top of the screen, and tap the message notification.
2. Tap **Call mailbox to listen to your voicemails?**

### Listen to your voice mail later

Tap **Phone**, and tap and hold **1**.

### Change your voice mailbox number later

Tap **Settings > Calls > Voice mailbox**. Then type in your voice mailbox number, and tap **✓**. To save the number, swipe up from the bottom of the screen, and tap **Confirm**.

# Camera

Why carry a separate camera if your phone has all you need for capturing memories? With your phone camera, you can easily take photos or record videos.

## Take a photo

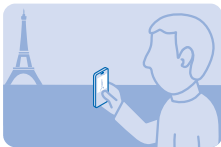

Capture the best moments with your phone camera.

1. To switch the camera on, tap **Camera**.
2. To zoom in or out, place two fingers on the screen, and slide them apart or together.
3. To access the settings, such as timer, white balance, or photo resolution, tap and hold the screen.
4. To take a photo, tap the screen.

The photos are saved in **Gallery**.

Keep a safe distance when using the flash. Do not use the flash on people or animals at close range. Do not cover the flash while taking a photo.

- ★ **Tip:** Need to capture a moment quickly? To switch on the camera when your phone is locked, swipe the lock screen up.
- ★ **Tip:** When the camera is open, it's easy to switch to video mode or go to **Gallery**. To switch the video camera on, swipe left from the centre of the screen. To go to **Gallery**, swipe right from the centre of the screen.

## Record a video

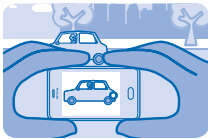

Besides taking photos, you can also record videos with your phone.

1. To switch the video camera on, tap **Camera**, and swipe left from the centre of the screen.
2. To zoom in or out, place two fingers on the screen, and slide them apart or together.
3. To start recording, tap the screen.
4. To stop recording, tap the screen.

Videos are saved in **Gallery**.

- ★ **Tip:** You can send your video in a multimedia or mail message. To limit the video size for sending, in video camera, before recording, tap and hold the screen, and switch **Video quality** to **Low**.

## Share your photo or video

Let others admire your great shots. Send them to your friends or share them on a social networking service.



1. Tap  **Gallery**.
2. Tap and hold the photo or video, and tap **Share**.

- ★ **Tip:** To share your photo straight to a social networking site, tap the logo of the social network.
3. Select how to share, and follow the instructions shown on the screen.

Not all sharing services support all file formats or videos recorded in high quality.

Using services or downloading content may cause the transfer of large amounts of data, which may result in data costs.

### Share your photo straight to a social networking site

To make your sharing even quicker, you can add a logo of your favourite social network site on the Gallery toolbar. Tap  **Settings** > **Sharing**, and switch **Instant sharing** to **On** .

# Maps & navigation

Explore what's out there and how to get there.

## Find nearby places



Explore the world around you – with Nokia Nearby, you can check for nearby places, such as restaurants and shopping centres.

1. Tap  **Nokia Nearby**.

2. To see a list of certain types of places, such as restaurants, tap the category. If you don't see the category you want in the main view, to see more categories, tap **More**.

★ **Tip:** To see the place on a map, tap the place, and in the place details view, tap **MAP**.

3. To search for a place, in the main view, write the place name in the search box.

★ **Tip:** You can save a place, so you can easily find it later. Tap the place and  > **SAVE**. To see your saved places, in the Nokia Nearby main view, tap **More** > .

Using services or downloading content may cause the transfer of large amounts of data, which may result in data costs.

This service may not be available in all countries or regions, and may be provided only in selected languages. The service may be network dependent. For more info, contact your network service provider.

Contents of digital maps may sometimes be inaccurate and incomplete. Never rely solely on the content or the service for essential communications, such as in emergencies.

 **Note:** Before sharing your location, always consider carefully with whom you are sharing. Check the privacy settings of the social networking service you are using, as you might share your location with a large group of people.

# Internet

Learn how to create wireless connections and browse the web while keeping your data costs down.

## Browse the web



Catch up on the news, and visit your favourite websites on the go.

★ **Tip:** If your network service provider doesn't charge you a fixed fee for data transfer, to save on data costs, use a Wi-Fi network to connect to the internet.

1. Tap **Internet**.

2. Write the web address in the address bar, and tap ✓.

★ **Tip:** To search the internet, write a search word in the address bar. If asked, select your default search engine.

### Zoom in or out

Place two fingers on the screen, and slide your fingers apart or together.

★ **Tip:** To view the page in a single column of larger, readable text and pictures without having to zoom in, swipe up from the bottom of the screen, tap **More > Settings**, and switch **Column view** to **On**.

### Share a web page

When browsing, swipe up from the bottom of the screen, and tap **Share** and how you want to share.

★ **Tip:** Follow your data usage with the Counters app.

## Add a website to your favourites



If you visit the same websites all the time, add them to your favourites so you can easily access them.

1. Tap **Internet**.

2. While browsing, swipe up from the bottom of the screen, and tap **Add to favourites**.

### Go to a favourite website

Swipe up from the bottom of the screen, tap **Favourites** and a favourite.

- ★ **Tip:** You can also pin your favourite websites to the apps menu. While browsing, swipe up from the bottom of the screen, and tap **Add to Home**.



# Entertainment

Having a spare moment and in need of entertainment? Learn how to listen to the radio on your phone.

## Play a song



You can use your phone's music player to listen to music and podcasts while on the move.

1. Tap  **Music**.
2. Tap **Songs, Artists, Playlists, or Albums**.
3. Tap a song.
4. To pause or resume playing, tap  or .

### Skip to the previous or next song

Tap  or .

### Rewind or fast-forward

Drag the slider.

### Play songs in a random order

Tap .

## Listen to the radio



You can listen to FM radio stations using your phone – just select a station.

To listen to the radio, you need to connect a compatible headset to the device. The headset acts as an antenna.

1. Tap  **FM radio**.
2. To tune in to the station you want to listen to, use your finger to rotate the wheel left or right.

# Office

Learn how to use the calendar to keep yourself organised.

## Change the time and date



You can set your phone clock manually.

Tap  **Settings** > **Time and date**.



### Change the time zone when travelling

Tap **Time zone**, and tap the time zone of your location. The time and date on your phone are set according to the time zone.

## Set an alarm



You can use your phone as an alarm clock.

1. Tap  **Alarms**.
2. Tap .
3. Set the alarm time.
4. To set the alarm to go off at the same time on certain days, swipe up from the bottom of the screen, tap **Repeat**, select the days, and tap **Done**.
5. To set a ringtone for the alarm, swipe up from the bottom of the screen, tap **Alarm tone**, select the ringtone, and tap **Set**.
6. Tap **Done**.

★ **Tip:** You can set multiple alarms. After you've set an alarm, tap  to set a new one.

## Add a calendar entry

Need to remember an event? Add it to your calendar.

1. Tap  **Calendar**.
2. Tap .



3. Edit the event details.

4. If the event is a birthday, set **Birthday** to **On** ☑.

5. Tap **Save**.

★ **Tip:** To delete an entry, tap and hold the entry, then tap **Delete**.

# Phone management & connectivity

Take care of your phone and its contents. Learn how to connect to accessories and networks, transfer files, create backups, lock your phone, and keep the software up to date.

## Share your content using Slam



Have a vacation photo you'd like to show your friend? Share things easily with Slam. Just move your phone close to another phone and content is transferred.

1. Switch Bluetooth on in both phones.
2. Make sure both phones are visible to other phones.
3. Tap, for example, a photo, and  **Slam via Bluetooth**.
4. Move your phone close to the other phone.

Slam searches for the nearest phone, and sends the item to it.

Operating the device in hidden mode is a safer way to avoid malicious software. Do not accept Bluetooth connection requests from sources you do not trust. You can also switch the Bluetooth function off when you are not using it.

## Connect to a Wi-Fi network



To help save on data costs, you can use a Wi-Fi network to connect to the internet, whether you're at home or at a library or internet café.

1. Swipe down from the top of the screen, and tap .
2. Tap **Wi-Fi** and the network you want.
3. If the connection is secured, type in the password.

### Connect to the previously used Wi-Fi network

Swipe down from the top of the screen, and tap .

### Add a new network

Swipe down from the top of the screen, tap **Wi-Fi**, make sure Wi-Fi is on, tap **Add new network**, and type in the required info.

## Close the Wi-Fi connection

Swipe down from the top of the screen, and tap .

- !** **Important:** Use encryption to increase the security of your Wi-Fi connection. Using encryption reduces the risk of others accessing your data.

## Copy content between your phone and computer



Copy photos, videos, music, and other content created by you (and stored on the memory card) between your phone and computer.

To copy content from the phone memory, you need to have a memory card inserted in your phone.

1. Connect your phone to a compatible computer with a compatible USB cable.
2. Tap **Mass storage**.
3. On your computer, open a file manager, such as Windows Explorer, and browse to your phone. You can see the content stored on the memory card.
4. Drag and drop items between your phone and computer.

## Update your phone software

Stay in step with the beat – update your phone software and apps to get new and enhanced features for your phone.

1. When your phone notifies you of an update, swipe down from the top of the screen, and tap the update notification.
2. To download and install an update, tap **Update**, and follow the instructions shown on the phone. The update may take several minutes. If you encounter problems, contact your network service provider.

After the update, go to [www.nokia.com/support](http://www.nokia.com/support) to get your new user guide.

Your network service provider may send updates over the air directly to your phone. For more info on this service, contact your network service provider.



Using services or downloading content may cause the transfer of large amounts of data, which may result in data costs.

Before starting the update, connect a charger or make sure the device battery has enough power.

- !** **Warning:** If you install a software update, you cannot use the device, even to make emergency calls, until the installation is completed and the device is restarted.

## Use your phone in flight mode

In places where you're not allowed to connect to the internet with your phone, you can still access your music, videos, and offline games if you switch flight mode on.

1. Tap  **Settings**.
2. Switch **Flight mode** to **On** .

### Switch flight mode off

Tap  **Settings**, and switch **Flight mode** to **Off** .

Flight mode closes connections to the mobile network and switches your phone's wireless features off. Comply with the instructions and safety requirements given by, for example, an airline, and any applicable laws and regulations. Where allowed, you can connect to a Wi-Fi network to, for example, browse the internet or switch Bluetooth on in flight mode.

 **Warning:** When the flight profile is activated, you cannot make or receive any calls, including emergency calls, or use other features that require network coverage. To make a call, switch to another profile.

## Access codes

Ever wondered what the different codes on your phone are for?

---

PIN or PIN2 code  
(4-8 digits)

These protect your SIM card against unauthorised use or are required to access some features.

You can set your phone to ask for the PIN code when you switch it on.

If you forget the codes or they aren't supplied with your card, contact your network service provider.

If you type in the code incorrectly 3 times in a row, you need to unblock the code with the PUK or PUK2 code.

---

PUK or PUK2

These are required to unblock a PIN or PIN2 code.

If not supplied with your SIM card, contact your network service provider.

---

Security code (lock code, password)

This helps you protect your phone against unauthorised use.

You can set your phone to ask for the lock code that you define.

Keep the code secret and in a safe place, separate from your phone.

---

---

If you forget the code and your phone is locked, your phone will require service. Additional charges may apply, and all the personal data on your phone may be deleted.

For more information, contact Nokia Care or your phone dealer.

---

IMEI

This is used to identify phones in the network. You may also need to give the number to Nokia Care services.

To view your IMEI number, dial **\*#06#**.

---

# Product and safety information

## Network services and costs

You can only use your device on the GSM 900, 1800 MHz networks. You need a subscription with a service provider.

Using some features and downloading content require a network connection and may result in data costs. You may also need to subscribe to some features.

## Emergency calls

1. Make sure the device is switched on.
2. Check for adequate signal strength.

You may also need to do the following:

- Put a SIM card in the device, if supported by your device.
  - Switch the call restrictions off in your device, such as call barring, fixed dialling, or closed user group.
  - Make sure the flight profile is not activated.
  - If the device screen and/or keys are locked, unlock them.
3. Press the back key repeatedly, until the home screen is shown.
  4. To open the dialler, select  Phone.
  5. Type in the official emergency number for your present location. Emergency call numbers vary by location.
  6. Select .
  7. Give the necessary info as accurately as possible. Do not end the call until given permission to do so.

To make an emergency call during the first start-up, tap .

-  **Important:** Activate both cellular and internet calls, if your phone supports internet calls. The phone may attempt to make emergency calls both through cellular networks and through your internet call service provider. Connections in all conditions cannot be guaranteed. Never rely solely on any wireless phone for essential communications like medical emergencies.

## Take care of your device

Handle your device, battery, charger and accessories with care. The following suggestions help you keep your device operational.

- Keep the device dry. Precipitation, humidity, and all types of liquids or moisture can contain minerals that corrode electronic circuits. If your device gets wet, remove the battery, and let the device dry.
- Do not use or store the device in dusty or dirty areas.
- Do not store the device in high temperatures. High temperatures may damage the device or battery.
- Do not store the device in cold temperatures. When the device warms to its normal temperature, moisture can form inside the device and damage it.
- Do not open the device other than as instructed in the user guide.
- Unauthorised modifications may damage the device and violate regulations governing radio devices.
- Do not drop, knock, or shake the device. Rough handling can break it.
- Only use a soft, clean, dry cloth to clean the surface of the device.
- Do not paint the device. Paint can prevent proper operation.
- For optimal performance, switch the device off and remove the battery from time to time.
- Keep the device away from magnets or magnetic fields.
- To keep your important data safe, store it in at least two separate places, such as your device, memory card, or computer, or write down important info.

### Recycle



Always return your used electronic products, batteries, and packaging materials to dedicated collection points. This way you help prevent uncontrolled waste disposal and promote the recycling of materials. All materials of the device can be recovered as materials and energy. Check how to recycle your Nokia products at [www.nokia.com/recycle](http://www.nokia.com/recycle).

#### Crossed-out wheeled-bin symbol



The crossed-out wheeled-bin symbol on your product, battery, literature, or packaging reminds you that all electrical and electronic products and batteries must be taken to separate collection at the end of their working life. Do not dispose of these products as unsorted municipal waste: take them for recycling. For info on your nearest recycling point, check with your local waste authority, or go to [www.nokia.com/support](http://www.nokia.com/support). For more info on the environmental attributes of your device, see [www.nokia.com/ecoprofile](http://www.nokia.com/ecoprofile).

## About Digital Rights Management

When using this device, obey all laws and respect local customs, privacy and legitimate rights of others, including copyrights. Copyright protection may prevent you from copying, modifying, or transferring photos, music, and other content.

Digital rights management (DRM) protected content comes with an associated licence that defines your rights to use the content.

With this device you can access content protected with OMA DRM 1.0. If certain DRM software fails to protect the content, content owners may ask that such DRM software's ability to access new DRM-protected content be revoked. Revocation may also prevent renewal of such DRM-protected content already in your device. Revocation of such DRM software does not affect the use of content protected with other types of DRM or the use of non-DRM-protected content.

## Battery and charger info

Use your device only with an original BL-5A rechargeable battery.

Charge your device with AC-20 charger. Charger plug type may vary.

Nokia may make additional battery or charger models available for this device.

**!** **Important:** Talk and standby times are estimates only. Actual times are affected by, for example, network conditions, device settings, features being used, battery condition, and temperature.

## Battery and charger safety

Always switch the device off and unplug the charger before removing the battery. To unplug a charger or an accessory, hold and pull the plug, not the cord.

When your charger is not in use, unplug it. If left unused, a fully charged battery will lose its charge over time.

Always keep the battery between 15°C and 25°C (59°F and 77°F) for optimal performance. Extreme temperatures reduce the capacity and lifetime of the battery. A device with a hot or cold battery may not work temporarily.

Accidental short-circuiting can happen when a metallic object touches the metal strips on the battery. This may damage the battery or the other object.

Do not dispose of batteries in a fire as they may explode. Obey local regulations. Recycle when possible. Do not dispose as household waste.

Do not dismantle, cut, crush, bend, puncture, or otherwise damage the battery in any way. If a battery leaks, do not let liquid touch skin or eyes. If this happens, immediately flush the affected areas with water, or seek medical help. Do not modify, attempt to insert foreign objects into the battery, or immerse or expose it to water or other liquids. Batteries may explode if damaged.

Use the battery and charger for their intended purposes only. Improper use, or use of unapproved or incompatible batteries or chargers may present a risk of fire, explosion, or other hazard, and may invalidate any approval or warranty. If you believe the battery or charger is damaged, take it to a service centre before continuing to use it. Never use a damaged battery or charger. Do not charge your device during a lightning storm. Only use the charger indoors.

## Additional safety information

### Small children

Your device and its accessories are not toys. They may contain small parts. Keep them out of the reach of small children.

### Medical devices

Operation of radio transmitting equipment, including wireless phones, may interfere with inadequately shielded medical devices' function. Consult a physician or the medical device's manufacturer to determine if it is adequately shielded from external radio energy.

### Implanted medical devices

To avoid potential interference, manufacturers of implanted medical devices recommend a minimum separation of 15.3 centimetres (6 inches) between a wireless device and the medical device. Persons who have such devices should:

- Always keep the wireless device more than 15.3 centimetres (6 inches) from the medical device.
- Not carry the wireless device in a breast pocket.
- Hold the wireless device to the ear opposite the medical device.
- Switch the wireless device off if there is any reason to suspect that interference is taking place.
- Follow the manufacturer directions for the implanted medical device.

If you have any questions about using your wireless device with an implanted medical device, consult your health care provider.

### Accessibility solutions

Nokia is committed to making mobile phones easy to use for all individuals, including those with disabilities. For more information, visit the Nokia website at [www.nokiaaccessibility.com](http://www.nokiaaccessibility.com).

### Hearing

 **Warning:** When you use the headset, your ability to hear outside sounds may be affected. Do not use the headset where it can endanger your safety.

Some wireless devices may interfere with some hearing aids.

### Nickel

The surface of this device is nickel-free.

### Protect your device from harmful content

Your device may be exposed to viruses and other harmful content. Take the following precautions:

- Be cautious when opening messages. They may contain malicious software or otherwise be harmful to your device or computer.
- Be cautious when accepting connectivity requests, browsing the internet, or downloading content. Do not accept Bluetooth connections from sources you do not trust.
- Only install and use services and software from sources that you trust and that offer adequate security and protection.
- Install antivirus and other security software on your device and any connected computer. Only use one antivirus app at a time. Using more may affect performance and operation of the device and/or computer.
- If you access preinstalled bookmarks and links to third party internet sites, take the appropriate precautions. Nokia does not endorse or assume liability for such sites.

### Vehicles

Radio signals may affect improperly installed or inadequately shielded electronic systems in vehicles. For more info, check with the manufacturer of your vehicle or its equipment.



Only qualified personnel should install the device in a vehicle. Faulty installation may be dangerous and invalidate your warranty. Check regularly that all wireless device equipment in your vehicle is mounted and operating properly. Do not store or carry flammable or explosive materials in the same compartment as the device, its parts, or accessories. Do not place your device or accessories in the air bag deployment area.

## Potentially explosive environments

Switch your device off in potentially explosive environments, such as near petrol pumps. Sparks may cause an explosion or fire resulting in injury or death. Note restrictions in areas with fuel; chemical plants; or where blasting operations are in progress. Areas with a potentially explosive environment may not be clearly marked. These usually are areas where you are advised to switch your engine off, below deck on boats, chemical transfer or storage facilities, and where the air contains chemicals or particles. Check with the manufacturers of vehicles using liquefied petroleum gas (such as propane or butane) if this device can be safely used in their vicinity.

## Certification information (SAR)

### This mobile device meets international guidelines for exposure to radio waves.

Your mobile device is a radio transmitter and receiver. It is designed not to exceed the limits for exposure to radio waves (radio frequency electromagnetic fields), recommended by international guidelines from the independent scientific organization ICNIRP. These guidelines incorporate substantial safety margins assure the protection of all persons regardless of age and health.

The exposure guidelines are based on the Specific Absorption Rate (SAR), which is an expression of the amount of radio frequency (RF) power deposited in the head or body when the device is transmitting. The ICNIRP SAR limit for mobile devices is 2.0 W/kg averaged over 10 grams of tissue.

SAR tests are carried out with the device in standard operating positions, transmitting at its highest certified power level, in all its frequency bands. The maximum recorded SAR values for this device are:

	Maximum SAR value	Frequency bands used when Maximum SAR value was recorded
When held against the head	0.89 W/kg over 10g	GSM900+WLAN2450
When operated at a separation distance of 1.5 centimetres (5/8 inch) from the body	0.51 W/kg over 10g	GSM900+WLAN2450

Your mobile device is also designed to meet the requirements for exposure to radio waves established by the India Department of Telecommunications. These requirements set a SAR limit of 1.6 W/kg averaged over one gram of tissue. The highest SAR value reported under this standard during product certification for use at the ear is:

	Maximum SAR value	Frequency bands used when Maximum SAR value was recorded
When held against the head	1.27 W/kg over 1g	GSM1800+WLAN2450

This device meets RF exposure guidelines when used against the head or when positioned at least 1.5 centimetres (5/8 inch) away from the body. When a carry case, belt clip or other form of device holder is used for body-worn operation, it should not contain metal and should provide at least the above stated separation distance from the body.

To send data or messages, a good connection to the network is needed. Sending may be delayed until such a connection is available. Follow the separation distance instructions until the sending is finished.

During general use, the SAR values are usually well below the values stated above. This is because, for purposes of system efficiency and to minimise interference on the network, the operating power of your mobile is automatically decreased when full power is not needed for the call. The lower the power output, the lower the SAR value.

Device models may have different versions and more than one value. Component and design changes may occur over time and some changes could affect SAR values. The latest available SAR information for this and other Nokia device models can be found at [www.nokia.com/sar](http://www.nokia.com/sar).

The World Health Organization (WHO) has stated that current scientific information does not indicate the need for any special precautions when using mobile devices. If you are interested in reducing your exposure, they recommend you limit your usage or use a hands-free kit to keep the device away from your head and body. For more information and explanations and discussions on RF exposure, go to the WHO website at [www.who.int/peh-emf/en](http://www.who.int/peh-emf/en).

## Nokia original accessories

For availability of approved accessories, check with your dealer.

An extensive range of accessories is available for your device. For more details, see [www.nokia.com/accessories](http://www.nokia.com/accessories).

### Practical rules about accessories

- Keep all accessories out of the reach of small children.
- When you disconnect the power cord of any accessory, grasp and pull the plug, not the cord.
- Check regularly that accessories installed in a vehicle are mounted and are operating properly.
- Installation of any complex car accessories must be made by qualified personnel only.

### Battery

Type: BL-5A

Talk time:

Up to 13.7 hours.

Standby:

Up to 24 days.

**!** **Important:** Battery talk and standby times are estimates only. Actual battery talk and standby times depend on SIM cards, features used, battery age and condition, temperatures to which battery is exposed, network conditions, and many other factors, and may be significantly shorter than those specified above. Ringing tones, hands free call handling, use in digital mode, and other features will also consume the battery, and the amount of time a device is used for calls will affect its stand-by time. Likewise, the amount of time that the device is turned on and in the standby mode will affect its talk time.

## Nokia support messages

To help you take maximum advantage of your phone and services, you receive free customised text messages from Nokia. The messages contain tips and tricks and support.

To stop receiving the messages, select **Accounts > Nokia account > Get news and offers**.

To provide the service described above, your mobile phone number, the serial number of your phone, and some identifiers of the mobile subscription are sent to Nokia when you use the phone for the first time. Some or all information may also be sent to Nokia when updating software. This information may be used as specified in the privacy policy, available at [www.nokia.com](http://www.nokia.com).

## Copyrights and other notices

### DECLARATION OF CONFORMITY

# CE 0168

Hereby, NOKIA CORPORATION declares that this RM-921 product is in compliance with the essential requirements and other relevant provisions of Directive 1999/5/EC. A copy of the Declaration of Conformity can be found at [www.nokia.com/global/declaration/declaration-of-conformity](http://www.nokia.com/global/declaration/declaration-of-conformity).

The availability of products, features, apps and services may vary by region. For more info, contact your Nokia dealer or your service provider. This device may contain commodities, technology or software subject to export laws and regulations from the US and other countries. Diversion contrary to law is prohibited.

The contents of this document are provided "as is". Except as required by applicable law, no warranties of any kind, either express or implied, including, but not limited to, the implied warranties of merchantability and fitness for a particular purpose, are made in relation to the accuracy, reliability or contents of this document. Nokia reserves the right to revise this document or withdraw it at any time without prior notice.

To the maximum extent permitted by applicable law, under no circumstances shall Nokia or any of its licensors be responsible for any loss of data or income or any special, incidental, consequential or indirect damages howsoever caused.

Reproduction, transfer or distribution of part or all of the contents in this document in any form without the prior written permission of Nokia is prohibited. Nokia operates a policy of continuous development. Nokia reserves the right to make changes and improvements to any of the products described in this document without prior notice.

Reverse engineering of software in the device is prohibited to the extent permitted by applicable law. Insofar as this user guide contains any limitations on Nokia's representations, warranties, damages and liabilities, such limitations shall likewise limit any representations, warranties, damages and liabilities of Nokia's licensors.

Nokia does not provide a warranty for or take any responsibility for the functionality, content, or end-user support of third-party apps provided with your device. By using an app, you acknowledge that the app is provided as is. Nokia does not make any representations, provide a warranty, or take any responsibility for the functionality, content, or end-user support of third-party apps provided with your device.

Downloading of maps, games, music and videos and uploading of images and videos may involve transferring large amounts of data. Your service provider may charge for the data transmission. The availability of particular products, services and features may vary by region. Please check with your local Nokia dealer for further details and availability of language options.

TM & © 2013 Nokia. All rights reserved. Third party products/names may be TMs of their respective owners.

The Bluetooth word mark and logos are owned by the Bluetooth SIG, Inc. and any use of such marks by Nokia is under license.



Oracle and Java are registered trademarks of Oracle and/or its affiliates.

This product is licensed under the MPEG-4 Visual Patent Portfolio License (i) for personal and noncommercial use in connection with information which has been encoded in compliance with the MPEG-4 Visual Standard by a consumer engaged in a personal and noncommercial activity and (ii) for use in connection with MPEG-4 video provided by a licensed video provider. No license is granted or shall be implied for any other use. Additional information, including that related to promotional, internal, and commercial uses, may be obtained from MPEG LA, LLC. See [www.mpegla.com](http://www.mpegla.com).

In the event of any inconsistencies between the English language version and any Indic language translation, the English language version shall always prevail over the Indic language translation.